



\$4,000*

Towards Closing Costs when
buyer uses one of our
Preferred Lenders

Whispering Lake

Quality Built Custom Homes

Now Pre-Selling

New Homes

from the

\$200's

DIRECTIONS:

I-75 N. to Chastain Road exit, turn L (west), turn R on Main Street, then bear R on Moon Station Rd., L on Matlock. Subdivision on Left. R on Whispering Drive.



Dominic Bamford
Keller Williams Realty First Atlanta
mobile: 404-547-9871,
office: 404-531-5700
dominic@bamfordandcompany.com
www.BamfordAndCompany.com

SALES INFORMATION

678-753-6050

Info@BamfordAndCompany.com

Supreme Lending

Matt Garcia, Sr. Loan Officer

NMLS # 218245 ~ GA Lic. # 24481 ~ Br # 422918

mobile 678.523.0981 ~ fax 404.592.6487

Matt.Garcia@SupremeLending.com

www.SupremeSouth.com/mgarcia

Georgia Residential Mortgage Licensee

Starkey Mortgage

John Davis, Sr. Loan Officer

NMLS# 216222, GA License# 24412

mobile 404.461.3794 ~ e-fax 866.546.9061

jdavis@starkeymtg.com

www.Starkeymtg.com/lo/JohnDavis

Georgia Residential Mortgage Licensee



 Each Keller Williams Realty office is independently owned and operated. *\$2,000 Lender Closing Cost credit is reflected on final settlement statement when buyer uses one of our preferred lenders. \$2,000 Builder Closing Cost. This flyer is intended for professional and educational purposes only. This is not a guarantee of financing. All borrowers must meet certain underwriting guidelines and credit criteria. Rules and Regulations may apply. This advertisement is not intended to solicit property already listed. This does not guarantee nor assume liability for the content or accuracy of any information presented or contained herein. This information is not intended to be an indication of loan qualification, loan approval or a commitment to lend. Other limitations may apply. Supreme Lending NMLSID#2129, WR Starkey Mortgage, LLP NMLS#2146. This information is subject to changes, errors, omission, and prior sales. Builder reserves the right to approve any house on any lot. Finished home details may vary slightly. Dimensions, elevations and features are approximate and subject to change. Some lots have additional premiums that must be added to the base price. See agent for details.

Whispering Lake

Quality Built Custom Homes

FEATURES & BENEFITS

KITCHEN

- Standard hardwood or tile floors (per plan)
- Optional Kitchen Island (per plan)
- 36" High end stained custom cabinetry with soft close drawers & dove-tailed drawers
- Granite counters
- Under mount stainless double sink
- Generous appliance package-up to \$2,000
- Food disposal

BATHROOMS

- Ceramic tile flooring in all bathrooms
- High end stained custom cabinetry (same as kitchen)
- Granite countertop in master & cultured marble in other bathrooms

INTERIOR FEATURES

- Ceiling fans included in Family room & Master bedroom
- Pre-wired for ceiling fans in all other bedrooms
- Hardwood floors in entrance foyer
- 9' ceilings on 1st floor (per plan)
- Vaulted & Trey ceilings (per plan)
- Direct vent gas log fireplace in family room
- No vinyl flooring
- Oil rubbed bronze hardware

EXTERIOR FEATURES

- Architectural style roof shingles – lifetime warranty
- Brick or stacked stone accents
- Concrete based lap siding
- Musket brown 6" gutters with downspouts and splash guards
- Thermal pane low E quality windows
- 2 outside water faucets one on each side of the home
- 2 outside GFCI outlets, 1 front & 1 back
- Professionally landscaped – sodded yards & shrubbery package
- Sentricon® ProActive termite control system
- Insulated garage doors & openers included!
- 10' x 10' concrete patio (slab houses per plan)
- Wood deck for basement homes (per plan)
- Custom mailboxes

INSPECTIONS

- Pre-construction meeting
- Detailed quality check final inspection
- Home ownership orientation prior to Closing (by request)

BASEMENT

- 9 ft ceilings
- Easy to finish!!

SCHOOLS

- Kennesaw Elementary
- Awtrev Middle
- North Cobb High

Square Footage: 1793 - 1843

HOA: 840/yr, Initiation: \$500

Amenities: Lake & Walking trails



Dominic Bamford
Keller Williams Realty First Atlanta
mobile: 404-547-9871
office: 404-531-5700
dominic@bamfordandcompany.com
www.BamfordAndCompany.com

SALES INFORMATION

678-753-6050

Info@BamfordAndCompany.com



Each Keller Williams Realty office is independently owned and operated. This information is subject to changes, errors, omission, and prior sales. Builder reserves the right to approve any house on any lot. Finished home details may vary slightly. Dimensions, elevations and features are approximate and subject to change. Some lots have additional premiums that must be added to the base price. See agent for details.

Whispering Lake

Quality Built Custom Homes

BASE PRICE & LOT ADDRESSES

Lot 10 --- \$229,900

Lot 11 --- \$234,900

LOT ADDRESSES

*Lot 10 – 2347 Whispering Drive

*Lot 11 – 2349 Whispering Drive NW

~~Lot 28 – 2391 Whispering Drive NW~~

~~Lot 29 – 2393 Whispering Drive NW~~

~~Lot 30 – 2395 Whispering Drive NW~~

~~Lot 31 – 2397 Whispering Drive NW~~

**Call agent for more information on Lot 10 & 11*

*SOLD, RESERVED AND UNDER CONTRACT LOTS***

SALE INFORMATION

678-753-6050

Info@BamfordAndCompany.com



Each Keller Williams Realty office is independently owned and operated. This information is subject to changes, errors, omission, and prior sales. Builder reserves the right to approve any house on any lot. Finished home details may vary slightly. Dimensions, elevations and features are approximate and subject to change. Some lots have additional premiums that must be added to the base price. See agent for details.

Whispering Lake

Quality Built Custom Homes

SITE PLAN

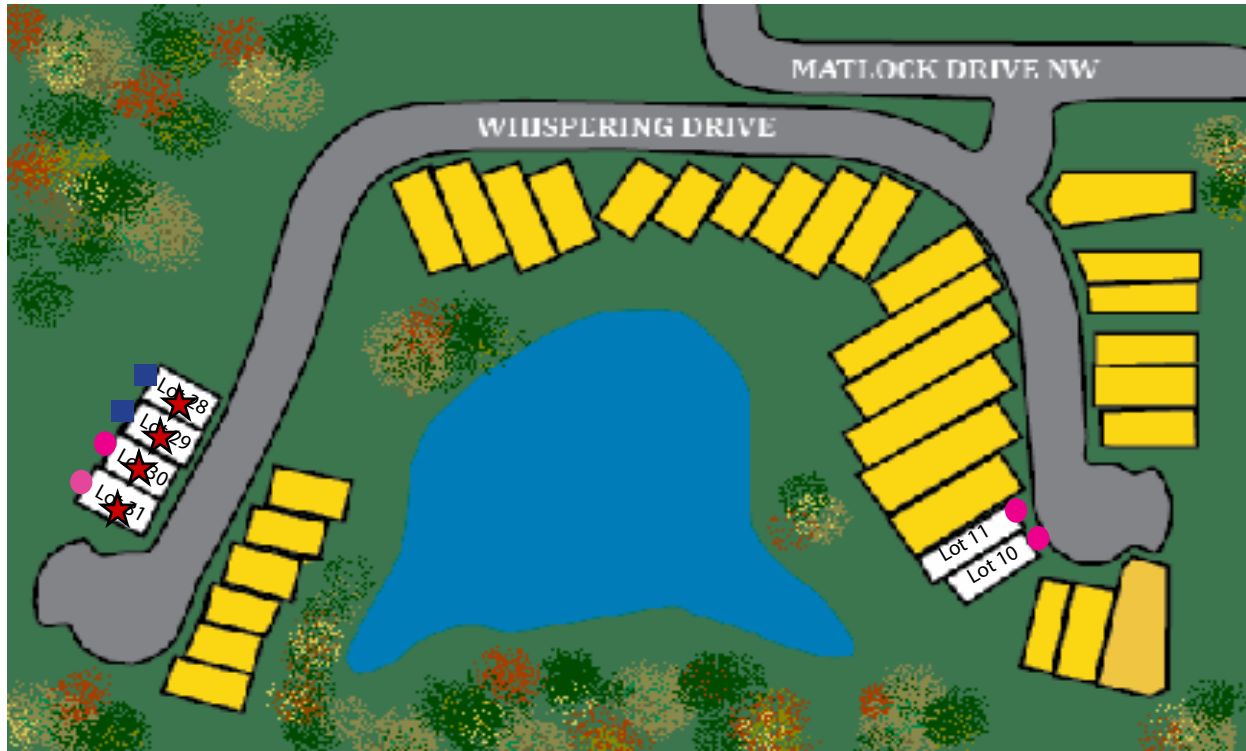

- Slab Lot
- ★ Sold Lot
- ★ Under Contract Lot
- Basement Lot
- ☆ Reserved

SALE INFORMATION

678-753-6050

Info@BamfordAndCompany.com



Dominic Bamford
Keller Williams Realty First Atlanta
mobile: 404-547-9871
office: 404-531-5700
dominic@bamfordandcompany.com
www.BamfordAndCompany.com

Whispering Lake

Quality Built Custom Homes

LOT 10

3 Bedrooms 2.5 Bathrooms



Lot 10 First Floor



Lot 10 Second Floor

SALE INFORMATION

678-753-6050

Info@BamfordAndCompany.com



Each Keller Williams Realty office is independently owned and operated. This information is subject to changes, errors, omission, and prior sales. Builder reserves the right to approve any house on any lot. Finished home details may vary slightly. Dimensions, elevations and features are approximate and subject to change. Some lots have additional premiums that must be added to the base price. See agent for details.

Whispering Lake

Quality Built Custom Homes

LOT 11

3 Bedrooms 2.5 Bathrooms



Lot 11 First Floor

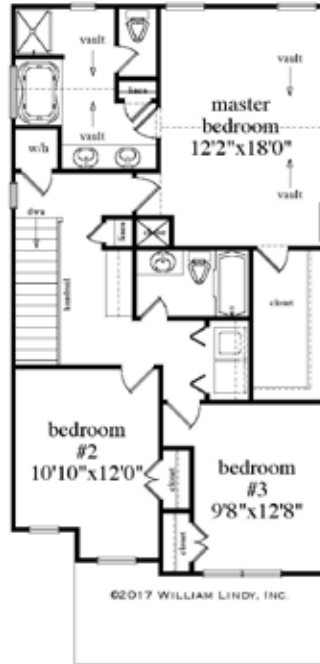

Lot 11 Second Floor

SALE INFORMATION

678-753-6050

Info@BamfordAndCompany.com



Each Keller Williams Realty office is independently owned and operated. This information is subject to changes, errors, omission, and prior sales. Builder reserves the right to approve any house on any lot. Finished home details may vary slightly. Dimensions, elevations and features are approximate and subject to change. Some lots have additional premiums that must be added to the base price. See agent for details.